

GCL-J

STANDARD-DUTY JACKSHAFT OPERATOR



The GCL-J is designed for high or full-lift sectional and rolling doors that have up to a 30-cycle/hour and less than 50-cycles/day duty requirement. Advanced features and robust mechanical design combine to provide a standard-duty operator that sets a new standard for productivity.

UL 325 Listed

- Allows for monitored entrapment protection and momentary operation when used with select photoeyes and/or edge-sensing devices.
- See back for approved list of monitored devices.

GCL-J Advantages

- MultiVolt® - Order phase specific operator for the job and have the ability to select the right voltage on the job site.
 - Single Phase: 115/208/230 VAC
 - Three Phase: 208/230/460 VAC
 - Three Phase: 575 VAC
- Modular design with optional expansion boards for advanced timer to close, edge sensing and auxiliary output functionality.
- LCD display with intuitive setup menu. Provides real-time status and trouble-shooting assistance.
- Internal receiver with the ability to individually add/delete up to 50 Intellicode® transmitters directly from the LCD display.
- EZ Limit® provides for push to set limits that remain synchronized with door even during long term loss of power.
- TensiBelt® primary drive reduction eliminates need to adjust belt tension.
- Open/close/stop and setup keys included on control board. Keeps all controls near the LCD display convenient for set up.



Standard Features

- EZ Limit® electro-mechanical limits.
- MultiVolt® voltage simplification.
- Max run timer automatically adjusts to up and down run time.
- TensiBelt® primary reduction.
- Delay on reverse.
- 16-character LCD display.
- UL 325 Listed.
- Advanced radio receiver displays and stores activation by transmitter ID number on the LCD screen.
- 3-button control station.
- 2-year/20,000-cycle warranty.
- Programmable mid-stop.
- Pull cord release for emergency manual operation.
- On-board timed close.

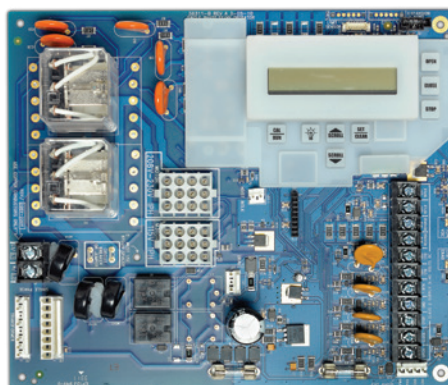

For more information on patents related to this product, visit <https://www.geniecompany.com/patents>.

©2025 The Genie Company | GCL-J



OFFICIAL GARAGE DOOR
OPENER
of the
Pro Football Hall of Fame



GCL-J | STANDARD-DUTY JACKSHAFT OPERATOR

| MAX DOOR SIZE (SQ*FT) - SECTIONAL | | | | | | | | | | | | | | | | | | |
|-----------------------------------|--------------------|--|------------|-------------|------------|-------|------------|---------------|--------------------|-------------|--------------|-----------|----------------------|---------------------------|---------------------------|------------------------|------------------|--------------------------|
| Door Series | | Commercial Steel Insulated & Non-Insulated | | | | | | | | Thermospan® | | | | ThermoMark™ | | | Aluminum | |
| | | 216 | 216 Ins. | 220 | 220 Ins. | 2415 | 2415 Ins. | 2411 | 2411 Ins. | 125 | 150 | 200 | 200-20 | 530 | 5150/5155 | 5200/5255 | 451/K-AL | 452/ 464 / K-AL |
| | | Flush | | Ribbed | | | | | | Insulated | | | | Insulated | | | | |
| Model | Max Door Wt. (lbs) | 16GA. | 16GA. Ins. | 20GA. Steel | 20GA. Ins. | 24GA. | 24GA. Ins. | Nominal 24GA. | Nominal 24GA. Ins. | PU-FIP | PU-FIP 1.38" | PU-FIP 2" | PU-FIP 2" 20GA. Ext. | PU-FIP Raised Panel 1.38" | PU-FIP Raised Panel 1.38" | PU-FIP Raised Panel 2" | 1/8" Glass 1.38" | 1/4" or 1/2" Glass 1.38" |
| 1/2 HP | 1120 | 256 | 220 | 370 | 256 | 440 | 340 | 320 | 320 | 256 | 360 | 400 | 300 | 360 | 400 | 380 | 360 | 240 |
| 3/4 HP | 1370 | 330 | 256 | 440 | 310 | 530 | 400 | 320 | 320 | 256 | 450 | 450 | 370 | 400 | 460 | 440 | 400 | 330 |
| 1 HP | 1620 | 380 | 280 | 500 | 370 | 570 | 410 | 320 | 320 | 256 | 480 | 480 | 420 | 460 | 500 | 480 | 400 | 400 |

| MAX DOOR SIZE (SQ*FT) - ROLLING | | | | | | | | | | | | | | | | | | | | | | | | | |
|---------------------------------|---------------------|---------------------|--------|--------|--------|--------|--------|-----------------|--------|--------|---------------|----------|----------|----------|--------------------|--------|--------------------|--------|--------|--------|------------------------------|--------|----------|--------|-----|
| Door Series | | Steel Non-Insulated | | | | | | Steel Insulated | | | Counter Doors | | Grilles | | FireStar® 2" Slat⁴ | | FireStar® 3" Slat⁴ | | | | FireStar® 3" Slat Insulated⁴ | | Shutters | Sheet | |
| HP/ Voltage | Max Door Wt. (lbs.) | 16 GA. | 18 GA. | 20 GA. | 22 GA. | 24 GA. | 26 GA. | 18 GA. | 20 GA. | 22 GA. | Aluminum | STL/ SST | Aluminum | STL/ SST | 20 GA. | 22 GA. | 16 GA. | 18 GA. | 20 GA. | 22 GA. | 20 GA. | 22 GA. | Aluminum | 26 GA. | |
| 1/2 HP | 998 | 297 | 333 | 333 | 416 | 476 | 476 | 238 | 238 | 274 | N/A | N/A | 350 | 240 | N/A | N/A | N/A | N/A | N/A | N/A | N/A | N/A | N/A | N/A | 256 |
| 3/4 HP | 1220 | 359 | 419 | 419 | 552 | 618 | N/A | 276 | 276 | 309 | N/A | N/A | 450 | 310 | N/A | N/A | N/A | N/A | N/A | N/A | N/A | N/A | N/A | N/A | N/A |
| 1 HP | 1440 | 388 | 461 | 461 | 606 | 621 | N/A | 297 | 296 | 382 | 126 | 126 | 610 | 450 | N/A | N/A | N/A | N/A | N/A | N/A | N/A | N/A | N/A | N/A | N/A |

Notes: 1. Max Door Weight and not the square footage, is the critical factor in selecting the proper operator.
2. Max Door Height 24'
3. For "Commercial Steel Insulated" category, various "backer" options are available. The chart above is based in all cases on the thickest backer available.
4. "PU-FIP" stands for "polyurethane, foamed-in-place." If no notation is present, insulation is "polystyrene laid-in-place."
5. GCL-J is UL Listed.

Construction

- **Motor**
AC continuous-duty motor. Motor replaceable without changing limits. Thermally protected.
- **Drive**
Primary — TensiBelt® auto tensioning poly-V J belt.
Secondary — chain and sprocket reduction.
- **Brake**
24 VDC disc brake standard on all models.
- **Friction Clutch**
Adjustable clutch to help protect against door and operator damage.
- **Precision Radial Ball Bearings**
Included in critical areas throughout the powertrain.
- **Emergency Manual Operation**
Pull cord disconnect disengages drive allowing door to be moved manually while maintaining limits.
- **Pre-wired to accept:**
 - Monitored entrapment device such as photoeyes.
 - Single or 3-button control stations.
 - External interlock switches.

| AMPERAGE RATING - 60Hz | | | | | | | |
|------------------------|----------|----------|----------|----------|----------|----------|----------|
| HP | 115V 1PH | 208V 1PH | 230V 1PH | 208V 3PH | 230V 3PH | 460V 3PH | 575V 3PH |
| 1/2 | 10 | 5 | 5 | 3 | 3 | 3 | 2 |
| 3/4 | 11 | 6 | 6 | 3 | 4 | 3 | 2 |
| 1 | 14 | 7 | 7 | 4 | 4 | 3 | 2 |

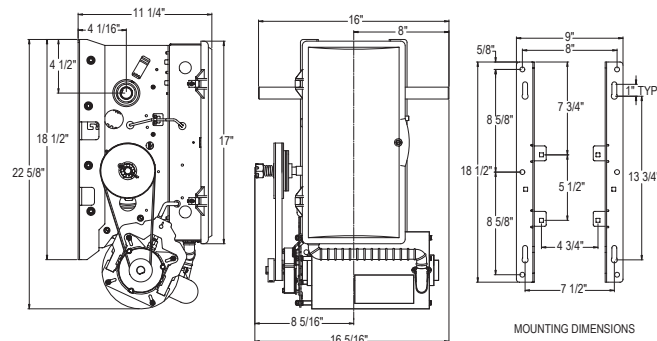

The Genie Company, One Door Drive, Mt. Hope, Ohio 44660

www.geniecompany.com/commercial | 1.800.843.4084

Item G001.0073 Rev. 12/24

Accessories and Options

- **Timer Close Module (TCM)**
This optional module plugs directly into the control board expansion port providing the operator with an automatic door closing feature with a user selectable time delay, adjustable from one second to five minutes (in increments of one second) using the LCD display. The module also includes pre-close warning output contacts, timer hold input, auxiliary open input, normally closed safety input, and monitored edges input.
- **Auxiliary Output Module (AOM)**
Provides relay contacts at the open, close, and mid-stop limits. Contacts for 5-minute lamp, and "ADA" contacts set via LCD display to warn during opening, closing or both.
- **Intellicode® Transmitters**
Available in single up to four button, or open/close/stop models.
- **Edge Sensing Module**
Input allows connection of a T3 monitored safety edge. When advanced timer close features are required, use the Timer Close Module.
- **Environmental Modifications**
Totally enclosed non-ventilated, or fan-cooled motors available - Must be ordered from the factory. NEMA 4 or NEMA 4X environmental modifications - Must be ordered from the factory.
- **UL 325 Approved Reversing Devices**
The installation of a monitored external entrapment device is required for momentary contact close operation on all commercial door operators. The following devices, when purchased through Genie, are UL Approved for use to meet this requirement:
 - Safe-T-Beam® Photoeye Kit with adjustable bracket (P/N 38176R.S).¹
 - Impact-protected Commercial Photoeye Kit (P/N OPAKPE2.S).
 - MillerEdge ME/MT/CPT (DC or T3) 2-wire edge sensor. Must be used with TCM (OPABTCGX.S), ESM (OPABESX.S), or Interface Module (OPAKMEIGX.S).
 - NEMA 4X Photocells (P/N: OPAKPEN4GX.S).
 - Retro-reflective NEMA 4X Photoeye Kit (P/N: OPGAKRPEN4X.S).
 - Monitored Light Curtains
 - 3 ft. length (P/N: OPAKMLC3.S).
 - 6ft. length (P/N: OPAKMLC6.S).
 - Light curtain mounting brackets (6 total) (P/N: 112809.0001.S).

¹ — Default device when operator is ordered.

Commercial Wi-Fi Module - Aladdin Connect®

This optional module plugs directly into the control board expansion port providing the operator with the ability to remotely monitor and control your commercial sectional garage door, with your smart device, from almost anywhere at any time while tracking the operation of your door (P/N: OPAKCDKM.S).

© 2025 The Genie Company. Genie and the Genie logo are registered trademarks of GMI Holdings, Inc., d/b/a The Genie Company. Consistent with our policy of continuing product improvement, we reserve the right to change product specifications without notice or obligation.